

'La Casa Portada'

Model 40818, 1,538 Sq. Ft.

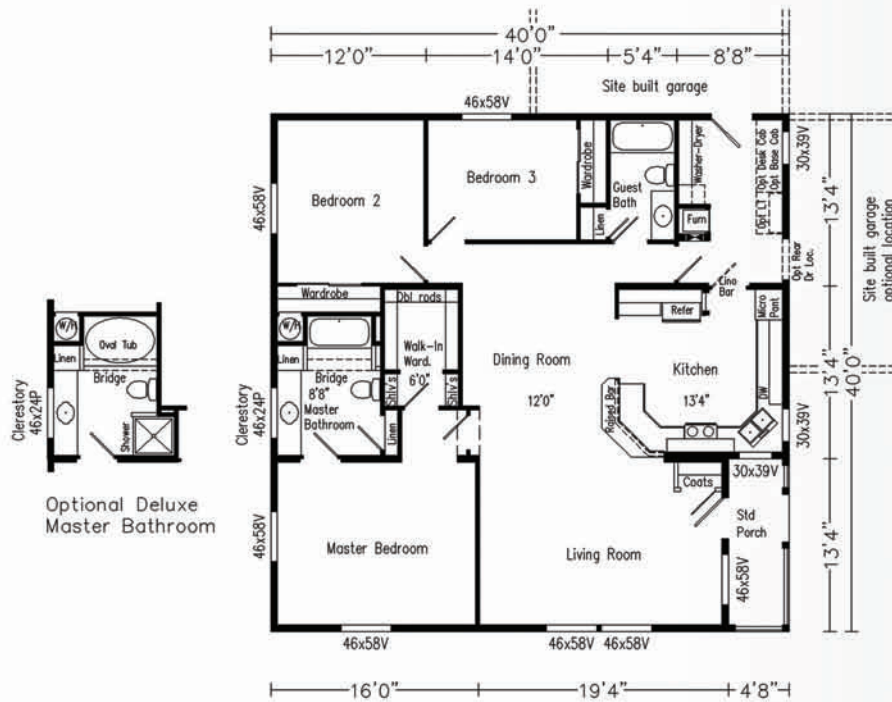

A corner porch provides an inviting front entry for this very special triple section plan. Designed for attached garage at side or end wall locations, as indicated by the dotted line reference marks, this home has the unique ability to fit in nearly any direction on a 50 foot property. Despite its compact configuration there is no lack of living space anywhere making this an excellent choice for a triple wide at a truly affordable price. Five recessed can lights are standard in the 10 ft. tall kitchen ceiling as is a standard clerestory window above the master bath vanity.

The "La Casa Portada" is shown in our artist's print with optional lap siding and grid mullion windows, standard corner porch and rails and a typical end wall site-built garage. See Concordia for view of optional end wall covered porch and typical side wall site-built garage.



H
N